



LEHRY VALVES

Where flow and pressure meets quality

UL & FM APPROVED - NRS TYPE GATE VALVE GROOVED End- PN16

LEHRY MAKE UL & FM Approved Non – Rising Type Grooved End are suitable for water are Coated with Epoxy resin

Features:

- ❖ Body, Bonnet, and wedge made of high strength ductile iron per ASTM A536 65-45-12.
- ❖ Interior and exterior of the valves are fusion bond epoxy coated.
- ❖ Each valve is equipped with a hand-wheel that indicates direction of opening.
- ❖ Packing is constructed of high quality graphite.
- ❖ Operating stems are made of Stainless steel.
- ❖ Wedge nuts are made of AISI 304 stainless steel.
- ❖ Grooved End

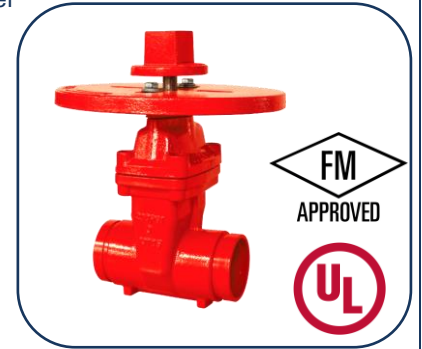

Applications:

- ❖ General Circuit water industries
- ❖ Flow Shut Off or Regulating Function in sectors including water supply of Fire Fighting.

Technical Specification

- ❖ Design Standard : AWWA C515
- ❖ Max. Working Pressure: PN 16 Bar (Max. Test Pressure : PN 24Bar)
- ❖ Application : Indoor and Outdoor Use
- ❖ Face to Face Standard : ASME B16.10
- ❖ Electrostatic spraying Both Inside & Outside of the Body

Valve Specifications:

SL No	Parts	Material
1	Body	DI (ASTM A536)
2	Disc	DI+EPDM
3 & 7	Nut & Retainer Ring	C95400
4	Gasket	EPDM
5	Stem	SS 304
6 & 9	Cap & Scotch	DI
8	O-Ring	EPDM
10 & 11	Mini Pad & Bolt	Steel
12 & 13	Bolt Stud & Blind Stud	Steel
14	Plain Washer	Steel
15 & 16	Coupling Flange & Platen	DI
17	Countersunk head bolt	Steel
18	Plug	C94500

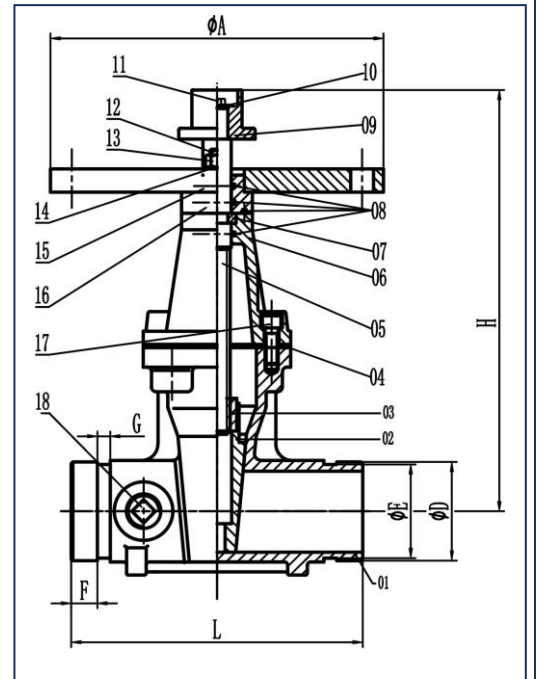

Dimensions

(All Dimensions are in mm)

Size	Inc	2"	2 ½"	3"	4"	5"	6"	8"	10"	12"
	MM	50	65	80	100	125	150	200	250	300
L		178	190	203	229	254	267	292	330	356
H		264	289	326	355	410	455	558	348	745
ØD		60.3	76.1	88.9	114.3	141.3	168.3	219.1	273	323.9
ØE		57.2	72.3	84.9	110.1	137	163.9	214.4	268.3	318.3
F		15.9	15.9	15.9	15.9	15.9	15.9	19	19	19
G		7.9	7.9	7.9	9.5	9.5	9.5	11.1	12.7	12.7

LEHRY INSTRUMENTATION & VALVES PVT. LTD

"Lehry Chambers" #78 (Old No.51) Sembudoss Street,
PB No. 1506, Parys Chennai - 600 001.

Chennai, Bangalore, Hyderabad, Vishakapatnam, Kolkata, Mumbai, Noida.
: 044-25226995, 25225185, 25226187

: info@lehry.com



: Chennai, Jalandhar, Ahmedabad.
: www.lehryvalves.com